

Fabric Stash Block

Oct/Nov 2010 QUILT Magazine, Issue #116

PLEASE NOTE: This fabric stash block first appeared in the Oct/Nov 2010 issue of QUILT Magazine. Many fabrics have a shelf life of about 6 months to 1 year. These exact fabrics may not still be available for purchase. Take heart! Your favorite quilt shop can help you select suitable substitutes in colors and patterns that will work just as well to make this block.



Stepping Squares

Breezy and light, a series of corners surrounds a center square. The Paisley Panache collection by Rosemarie Lavin for Windham Fabrics lends itself to this stunning design. www.windhamfabrics.com



A - Cut (1) 7-1/4" squares



B - Cut (4) 2-1/4" x 3-3/4" pieces



C - Cut (4) 2-1/4" x 3-3/4" pieces



D - Cut (8) 2-1/4" squares

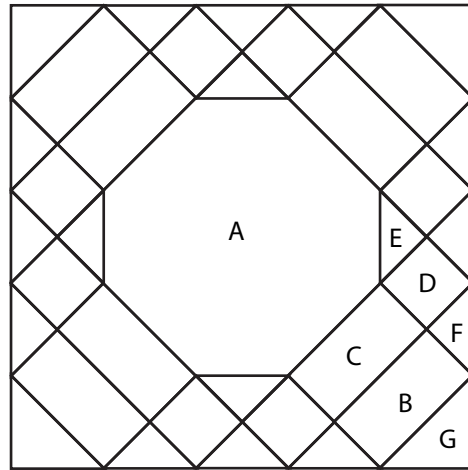

E - Cut (4) 2-1/4" squares



F - Cut (6) 2-5/8" squares, then cut in half diagonally once to make (12) small triangles



G - Cut (2) 2-5/8" squares, then cut in half diagonally once to make (4) corner triangles

ASSEMBLING THE BLOCK:

Refer to block picture above; draw a diagonal line on the wrong side of (4) E squares. Place a marked square on (1) corner of the A square. Sew on the drawn line. Trim 1/4" away from the seam and press the corner open. In the same manner add an E square to the remaining (3) corners of the A square.

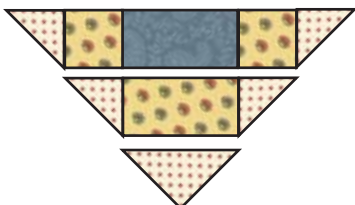
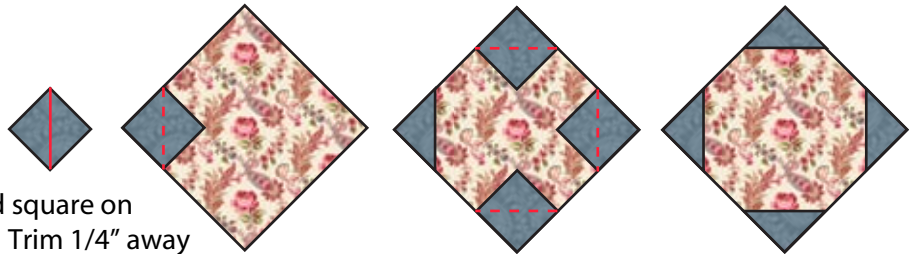

Stitch a D square to each end of a C piece to make a three-piece unit. Sew an F triangle to the end of the three-piece unit to make corner row 1. Sew an F triangle to each end of a B piece to make corner row 2. Sew row 1 to row 2. Add a G corner triangle to row 2 to make a corner unit. (Make 4 units.)

Sew a corner unit to each side of the A square to make the block. Trim to measure 12-1/2", if needed.