



(Pillow - 16" square)

Manly Appeal Pillow

"Manly Appeal" quilt patterned in
Winter 2010 issue of Quick Quilts Magazine

Web Bonus pattern for pillow by Lucy A. Fazely

From the Liz's Mercantile collection by Jodi Barrows for
Sullivans, www.sullivans.net

Materials You Will Need:

1/6 yard of a red wreath print
1/6 yard of a tan stem print
1/4 yard of a blue wreath print
1/4 yard of a cream stem print
3/4 yard of a black floral
17" square piece of Warm & White quilt batting
16" square pillow form

Cutting Directions:

From the red wreath print, cut:

(2) 3-7/8" squares

(4) 3-1/2" squares

From the tan stem print, cut:

(2) 3-7/8" squares

From the blue wreath print, cut:

(1) 6-7/8" square

From the cream stem print, cut:

(1) 6-7/8" square

From the black floral, cut:

(2) 2-1/2" x 42" strips; recut into (2) 2-1/2" x 16-1/2"
strips and (2) 2-1/2" x 12-1/2" strips

(1) 18" x 42" strip; recut into (1) 18" square and

(2) 12" x 16-1/2" backing pieces

Sewing Directions: *(Seam allowance is 1/4" unless stated otherwise)*

MAKING THE PILLOW

1. Cut each 6-7/8" square diagonally in half once. Sew together a 6-7/8" blue wreath triangle and cream stem triangle. Make a total of (2) large half-square triangle units.

2. In the same manner, make (4) small half-square triangle units using 3-7/8" red wreath and tan stem squares.

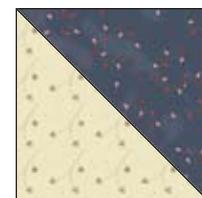

MAKE 2

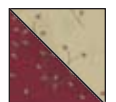

MAKE 4

3. Noting orientation, sew each small half-square triangle unit to a 3-1/2" red wreath square. Sew the units together to create a pieced four-patch.

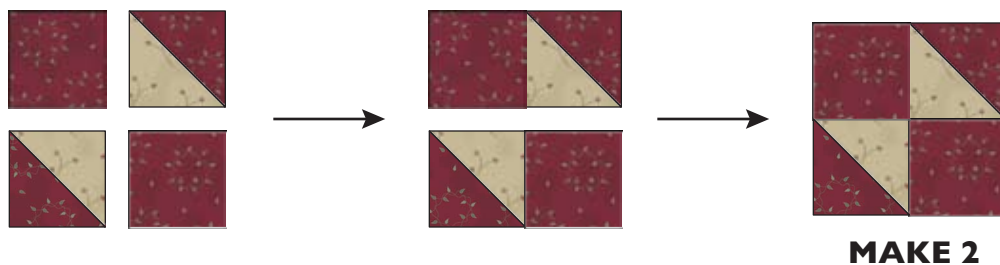

4. Noting orientation, sew each pieced four-patch to a large half square triangle unit from step 1. Sew the pieced units together to make a block.

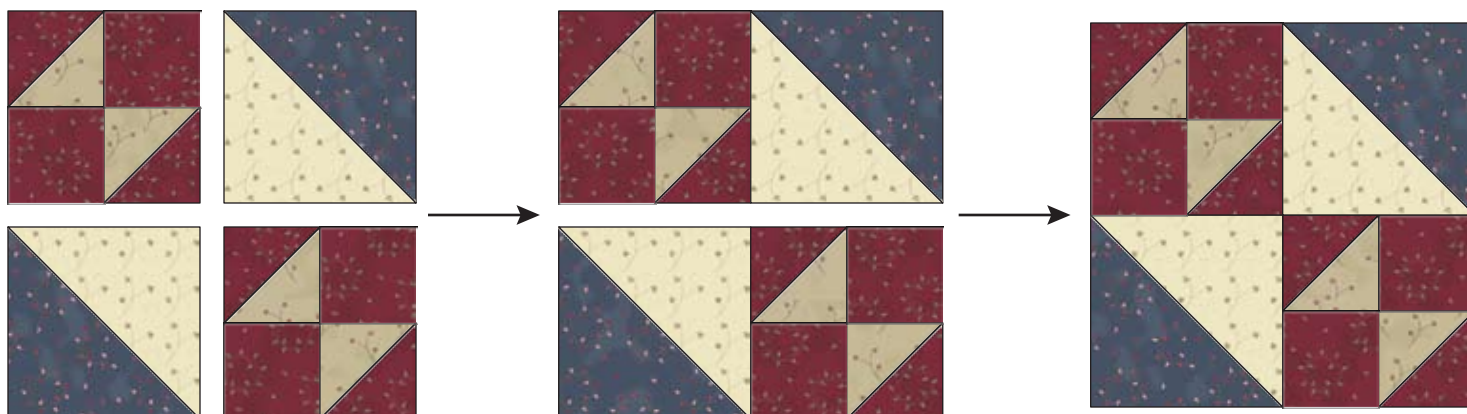

5. Sew 2-1/2" x 12-1/2" black floral strips to the sides of the block. Sew the 2-1/2" x 16-1/2" black floral strips to the top and bottom.

6. Spray baste the wrong side of the pillow top and center on 17" square of quilt batting. Spray baste the wrong side of the pillow top/batting and center over the 18" black floral square, right sides out.

7. Machine quilt, stitching in the ditch, along all seam lines of the pillow top. Trim the lining/batting even with the pillow top.

8. Fold one long edge, of each of the 12" x 16-1/2" black floral backing pieces, 1/4" to wrong side and press flat. Turn under another 1/4", press and stitch hem in place.

Lay the quilted pillow top right side up. Lay the backing pieces face down, with hemmed edges overlapping in the middle, on the pillow top with all the backing edges even with the pillow top. Pin in place. Stitch around all (4) sides of the pillow layers, 1/4" from the raw edges. Stitch around a second time for strength. Stitch around the raw edges using an overcast or zigzag stitch to prevent unraveling.

9. Turn pillow right side out and insert 16" square pillow form.